

EXHIBIT A
SHOWING THE LOCATION OF A VACATED ALLEY ADJACENT TO
LOTS 832 AND 836 SUNNYHILL ROAD, LOTS 118, 120, 132 AND
138, COOLIDGE STREET, LOT 148B (FORMERLY A PART OF LOT
148 COOLIDGE ST.) AND THE SOUTH PART OF LOT 19, BLOCK 1.
LOTS 111 AND 117 FOREST AVENUE AND LOT 127 ROOSEVELT
STREET, ALL IN MOULTON TERRACE ADDITION
SITUATED IN HOLLIE WILSON M.S. 277

 AREA OF VACATED ALLEY



- REBAR
- REBAR & CAP (VREM LS6577)
- REBAR & CAP (ARLETH LS3977)
- ▲ DRILL STEEL
- ◆ CORNER NOT FOUND

LINE	BEARING	DISTANCE
L1	S 84°36'58" E	16.35'
L2	S 16°12'12" E	173.76'
L3	S 31°27'52" E	110.95'
L4	S 31°27'52" E	87.02'
L5	S 52°58'42" W	7.00'
L6	S 33°44'07" E	22.83'
L7	S 61°21'07" W	22.21'
L8	N 29°29'36" W	55.09'
L9	N 27°32'01" W	35.11'
L10	S 72°18'16" W	1.20'
L11	N 29°08'00" W	78.08'
L12	N 23°39'24" W	73.44'
L13	N 14°52'37" W	101.14'
L14	N 16°42'29" W	61.79'

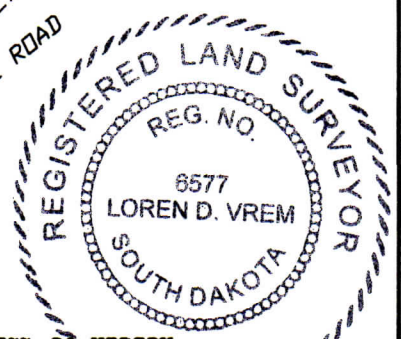
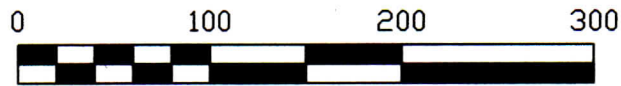

SURVEYOR'S CERTIFICATE
 I, LOREN D. VREM R.L.S. 6577, DO HEREBY
 CERTIFY THAT THE SURVEY SHOWN HEREON
 WAS SURVEYED UNDER MY SUPERVISION AND THAT
 ALL DIMENSIONS ARE TRUE AND CORRECT TO THE
 BEST OF MY KNOWLEDGE AND BELIEF.

LOREN D. VREM R.L.S. 6577 DATE 4/26/2024

 Prepared By:
PONDEROSA LAND SURVEYS, L.L.C.
 332A WEST MAIN ST.
 LEAD, SD 57754
 (605) 722-3840

Date:	4/26/2024
Drawn By:	L. D. VREM
Project No.:	24-97
Dwg. No.:	24-97.dwg